

APN01: 121.65(W)
 APN02: 121.975(E)
 APN03: 122.7(N)
 APN04: 122.6(S)

D-ATIS: 127.85
 GND01: 121.7
 GND02: 121.8
 GND03: 121.875
 GND04: 121.625
 121.95(121.625)
 for delivery(DCL AVBL) N31° 08.7'E121° 47.6' ELEV 4m

RWY17L/35R, 17R/35L: TWR01 118.8(118.325)
 RWY16L/34R, 16R/34L: TWR02 118.4(118.725)
 RWY17L/35R: TWR03 124.35(118.325)
 RWY16R/34L: TWR04 118.575(118.725)

ZSPD SHANGHAI/Pudong
 for delivery(DCL AVBL) N31° 08.7'E121° 47.6' ELEV 4m

AERODROME CHART

BEARINGS ARE MAGNETIC
 ALTITUDES, DISTANCES,
 ELEVATIONS AND HEIGHTS
 IN METERS

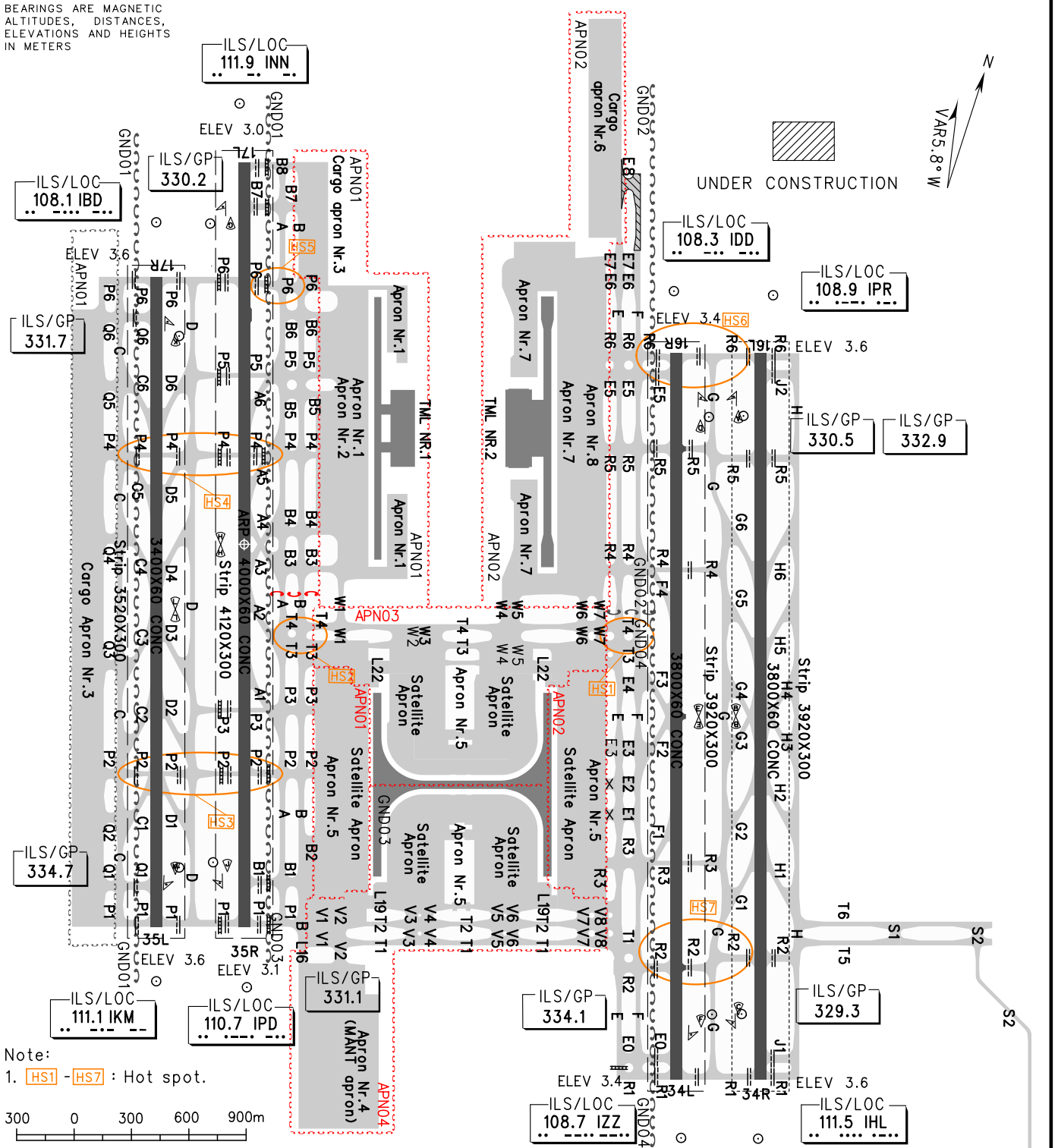

Note:
 1. **HS1 - HS7** : Hot spot.

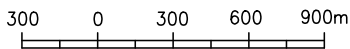

TAKE-OFF MINIMA(WITH RELIABLE ALTN)(m)				LIGHTS		
ACFT Type	LVP in force 17L/35R/34L		RWY16L/34R,16R/34L 17L/35R,17R/35L		16L/34R, 17R/35L	17L/35R, 16R/34L
	REDL&RCLL&RVRS	REDL&RCLL	REDL&RCLM	NIL(Day only)	PALS CAT I SFL PAPI REDL RCLL RENL	PALS CAT II/III SFL PAPI REDL RCLL TDZL RENL
2 TURB ENG or 3&4 ENG	A	RVR150	RVR200	RVR400		
	B	RVR150	RVR200	RVR500		
	C	RVR150	RVR200	VIS800		
	D	RVR200	RVR250	VIS800		

Changes: APN.