

22083

# AIRPORT DIAGRAM

AL-5091 (FAA)

SOUTHERN ILLINOIS (MDH)  
CARBONDALE-MURPHYSBORO, ILLINOIS

ATIS  
119.725  
CARBONDALE TOWER\*  
125.35 322.4  
GND CON  
121.8  
**D**

FIELD  
ELEV  
411

VAR 2.3° W  
JANUARY 2020  
ANNUAL RATE OF CHANGE  
0.1° W

RWY 06-24  
PCN 22 F/C/W/U  
S-36, D-47, 2D-70  
RWY 18L-36R  
PCN 50 F/C/W/U  
S-80, D-99.5, 2D-150  
RWY 18R-36L  
PCN 4 F/C/W/U  
S-30, D-42, 2D-60

EC-3, 21 MAR 2024 to 18 APR 2024

EC-3, 21 MAR 2024 to 18 APR 2024

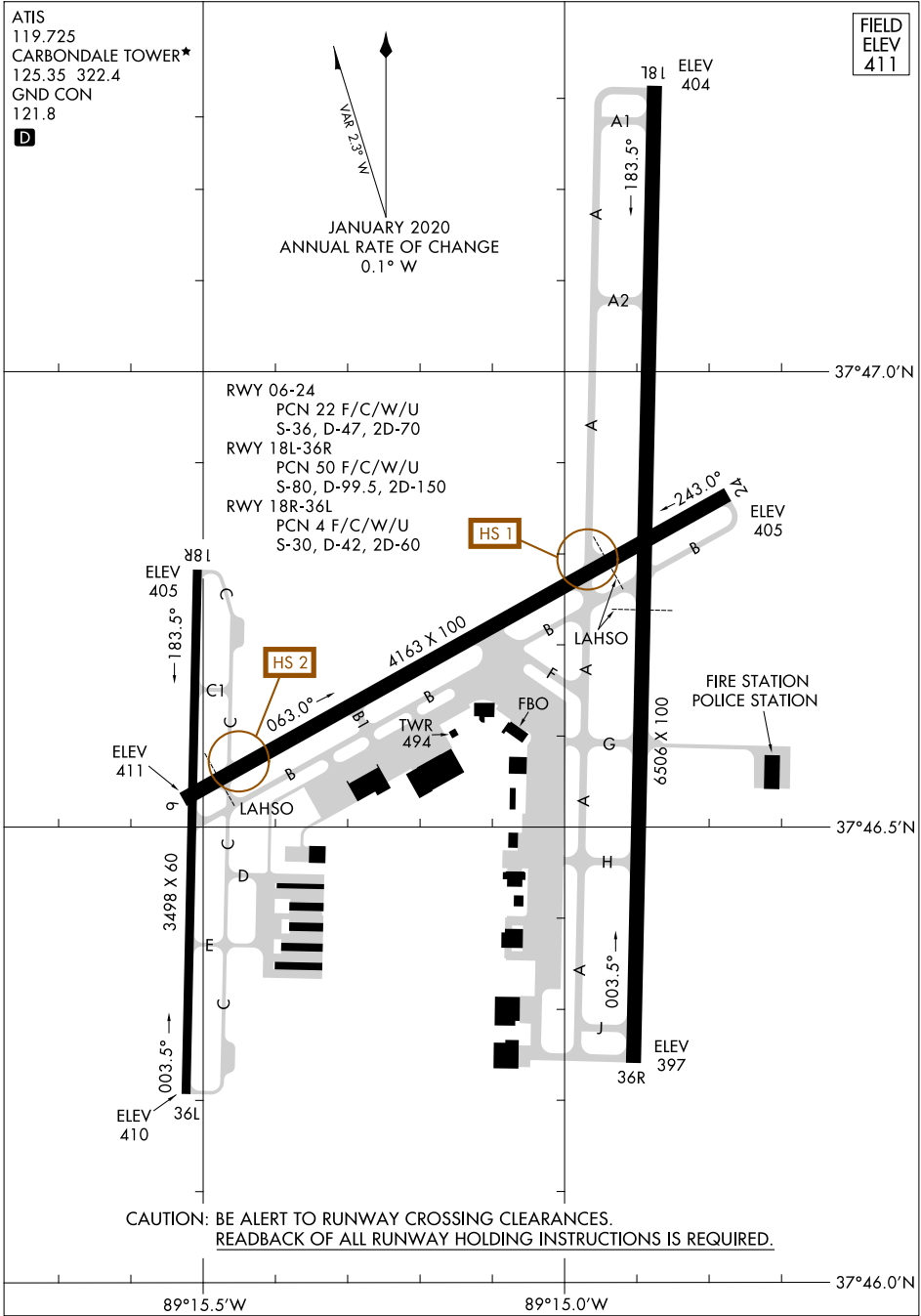

CAUTION: BE ALERT TO RUNWAY CROSSING CLEARANCES.  
READBCK OF ALL RUNWAY HOLDING INSTRUCTIONS IS REQUIRED.

# AIRPORT DIAGRAM

22083

CARBONDALE-MURPHYSBORO, ILLINOIS  
SOUTHERN ILLINOIS (MDH)