

**AERODROME
CHART - ICAO**

ARP 555700N 0032221W

AD ELEV 136FT

**EDINBURGH
EGPH**

RUNWAY/TAXIWAY/APRON PHYSICAL CHARACTERISTICS			
APRON / RWY / TWY	SURFACE	BEARING STRENGTH	ELEVATION
RWY 06/24	Grooved Asphalt	68/R/B/W/T	-
Main Apron	Concrete	72/R/C/W/T	97ft amsl
North Apron	Block Paving	31/F/C/X/T	103ft amsl
East Apron	Concrete	79/R/D/W/T	-
Southeast Apron	Concrete	72/R/C/W/T	-
Twy A (between A1 and A8 and A17 and D1)	Concrete	120/R/C/W/T	-
Twy A (between A8 and A17)	Asphalt	70/F/A/W/T	-
Twys E, F	Concrete	72/R/C/W/T	-
Twy G	Concrete	90/R/D/W/T	-
Twy H	Concrete	78/R/D/W/T	-
Twy L	Concrete	131/R/D/W/T	-
Twy M (Hold M1 to M2 and Hold M2 to M3)	Asphalt	58/F/B/X/T	-
Twy M (Hold M3 to Twy S), Twy Q	Asphalt	31/F/C/X/T	-
Twy P	Asphalt	82/R/D/W/T	-
Twy S	Concrete	79/R/D/W/T	-

COM		
ATIS	131.355	EDINBURGH TERMINAL INFO
TWR	118.705	EDINBURGH TOWER
	121.755 (GMC)	EDINBURGH GROUND
	121.600	EDINBURGH FIRE
LIGHTING		
THR 06/24	HI green with HI green W bars.	
RWY 06/24	HI bi-d edge. HI colour coded C/L. End lights red. TDZ 914m.	
TWY	Green C/L on 06/24 taxiways and from TWY M to North/Southeast and East aprons. Blue edge for all other taxiways. RWY 06/24 exits have Alt green/yellow lights to CAT II/III stop bars. RWY guard lights on accesses to RWY 06/24.	

GUND (Geoid Undulation) = The height of the Geoid (MSL) above the Reference Ellipsoid (WGS 84) at the stated position.	
BEARINGS ARE MAGNETIC ELEVATIONS AND HEIGHTS ARE IN FEET	
ELEVATIONS IN FEET AMSL	216
HEIGHTS IN FEET ABOVE AD	(80)

156 (20) 173 (37)

VAR 2.0°W - 2019
N
Annual Rate of Change 0.17°E

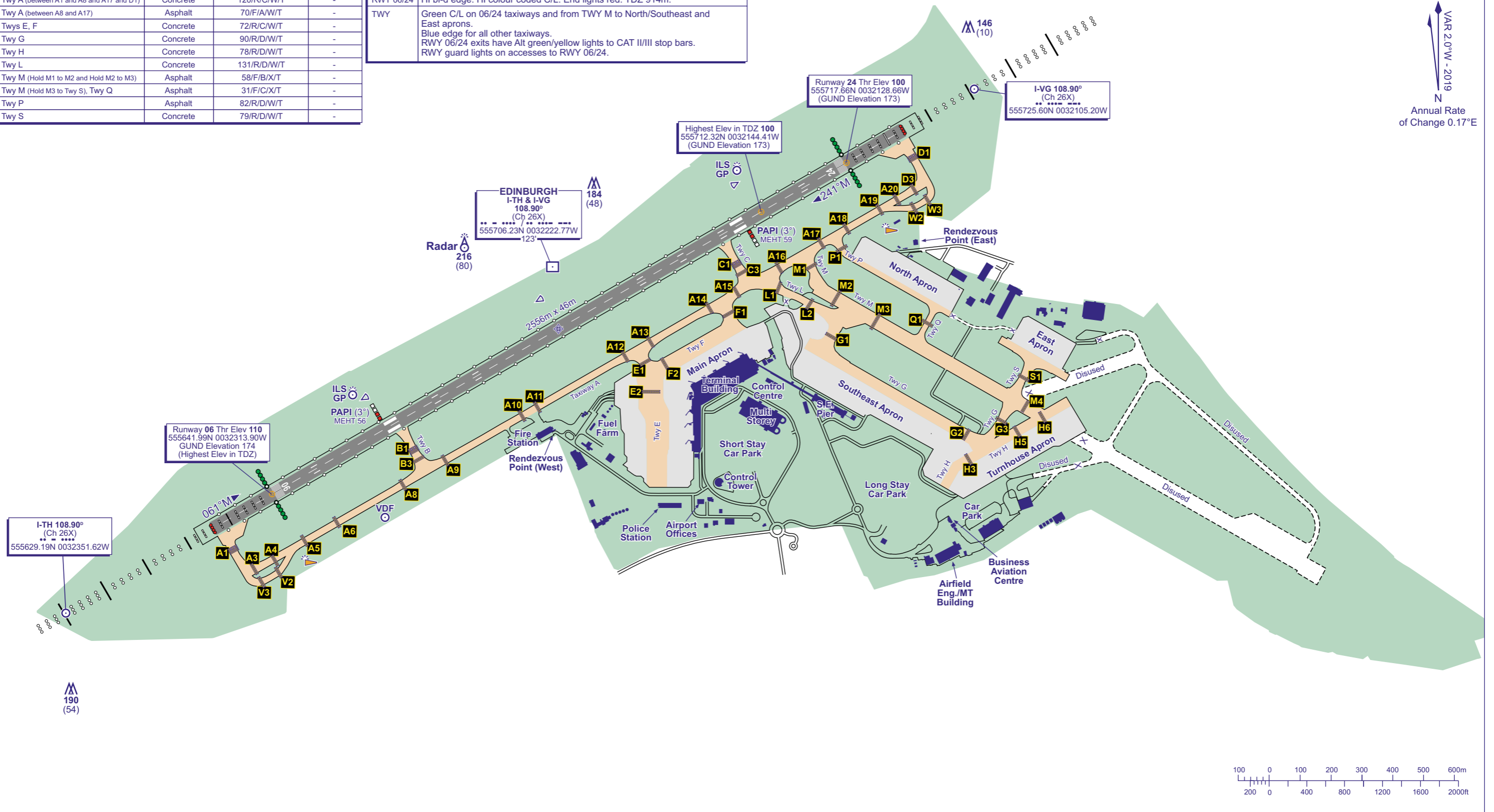

CHANGE (5/19): FREQUENCIES.

AERO INFO DATE 29 JAN 19

AD 2-EGPH-2-1