

AERODROME CHART – ICAO

38°46'27"N
009°08'03"W

ELEV 114 m

ATIS – 124.150 TWR – 118.100 /118.500
CLD – 118.950 /118.500 GND – 121.750 /118.500

LISBOA

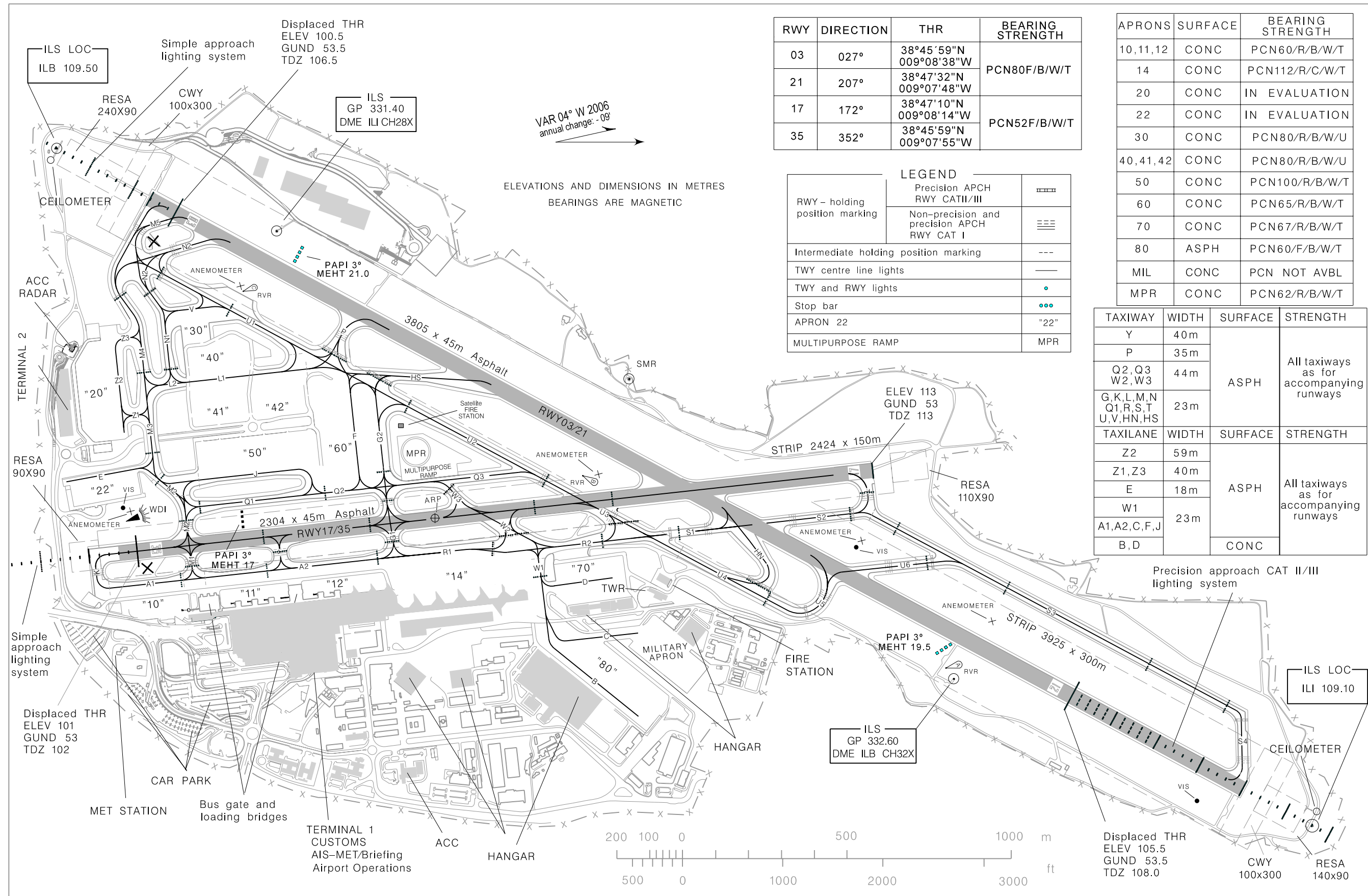

RWY	DIRECTION	THR	BEARING STRENGTH
03	027°	38°45'59"N 009°08'38"W	PCN80F/B/W/T
21	207°	38°47'32"N 009°07'48"W	
17	172°	38°47'10"N 009°08'14"W	PCN52F/B/W/T
35	352°	38°45'59"N 009°07'55"W	

APRONS	SURFACE	BEARING STRENGTH
10,11,12	CONC	PCN60/R/B/W/T
14	CONC	PCN112/R/C/W/T
20	CONC	IN EVALUATION
22	CONC	IN EVALUATION
30	CONC	PCN80/R/B/W/U
40,41,42	CONC	PCN80/R/B/W/U
50	CONC	PCN100/R/B/W/T
60	CONC	PCN65/R/B/W/T
70	CONC	PCN67/R/B/W/T
80	ASPH	PCN60/F/B/W/T
MIL	CONC	PCN NOT AVBL
MPR	CONC	PCN62/R/B/W/T

LEGEND

Precision APCH RWY CATII/III	
Non-precision and precision APCH RWY CAT I	
RWY - holding position marking	
Intermediate holding position marking	
TWY centre line lights	
TWY and RWY lights	
Stop bar	
APRON 22	"22"
MULTIPURPOSE RAMP	MPR

TAXIWAY	WIDTH	SURFACE	STRENGTH		
Y	40m	ASPH	All taxiways as for accompanying runways		
P	35m				
Q2,Q3 W2,W3	44m				
G,K,L,M,N Q1,R,S,T U,V,HN,HS	23m	ASPH	All taxiways as for accompanying runways		
TAXILANE	WIDTH			SURFACE	STRENGTH
Z2	59m			ASPH	All taxiways as for accompanying runways
Z1,Z3	40m				
E	18m				
W1	23m	CONC			
A1,A2,C,F,J					
B,D					